

2018 CITATION

William Marshal

LYCEUM

A traveling fellowship in Architecture

Crossroads



a Divided City

barriers:

- topography change
- railroad
- separation

needs:

- physical connection - a path
- social interaction - a public space
- cultural integration - a home

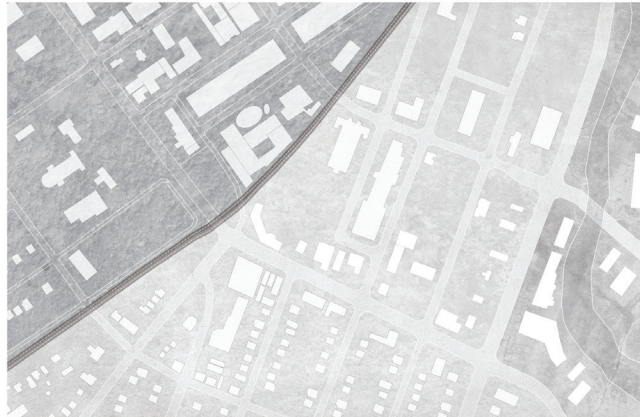

barrier of topography difference



barrier of railroad



separation of basilica, town core and transit station

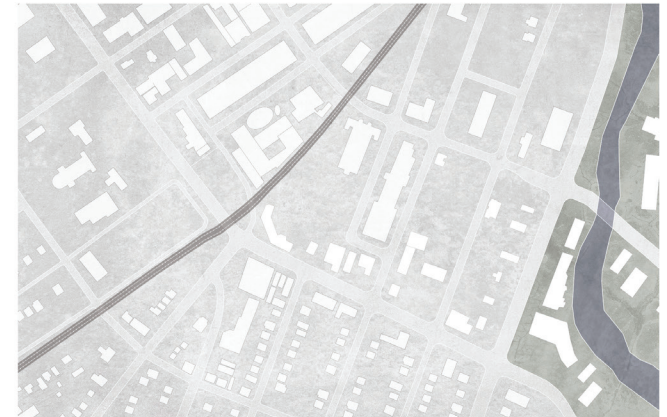

separation of riverfront

Mending the Gap

two connecting paths:

- a ground path, from downtown to the riverfront
- an elevated rail path, from the station to the basilica

at the intersection of paths, **a crossroads** forms

- an interchange - physical connection
- a place of activity - social interaction
- a center for trade - cultural integration

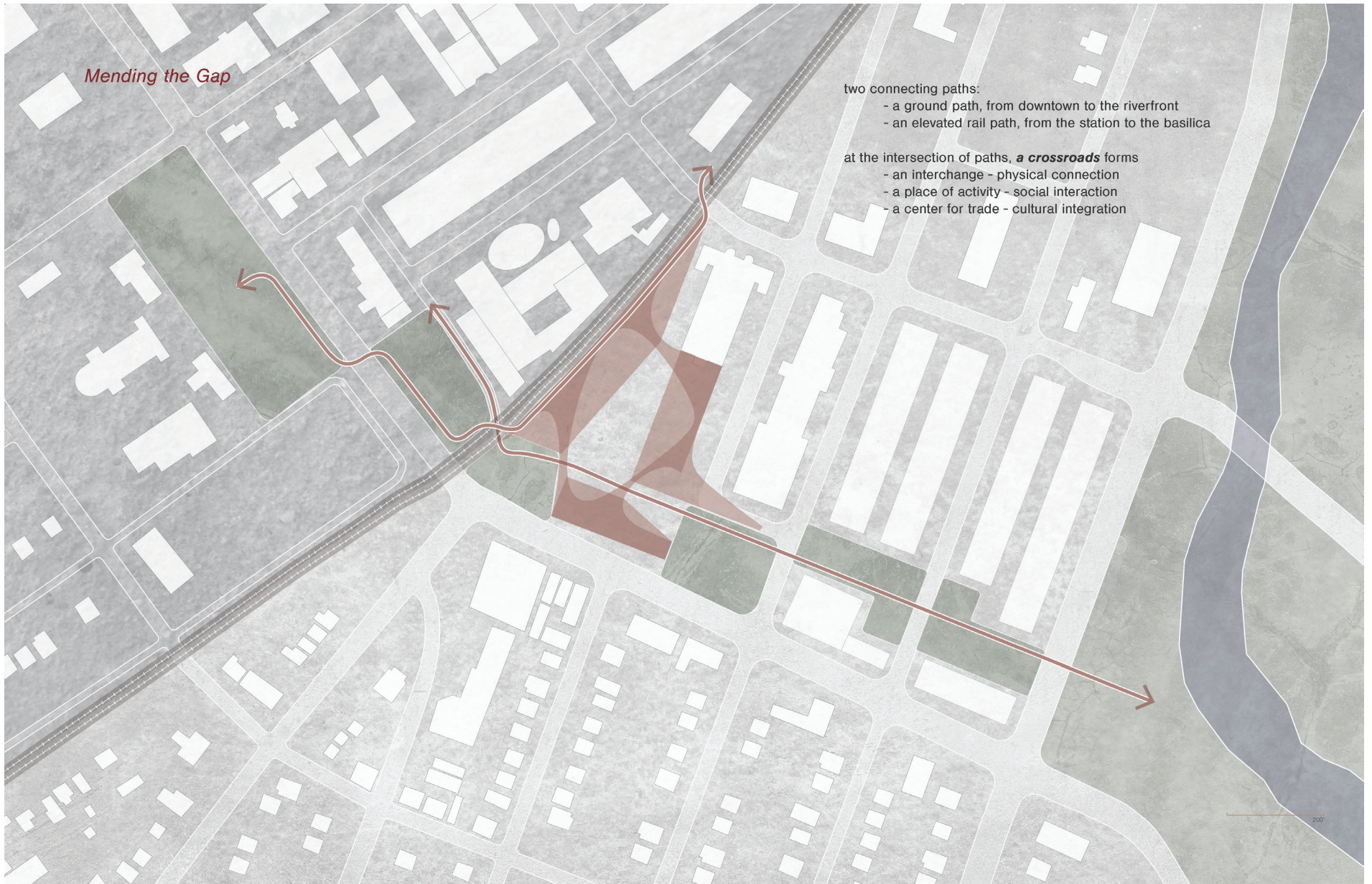

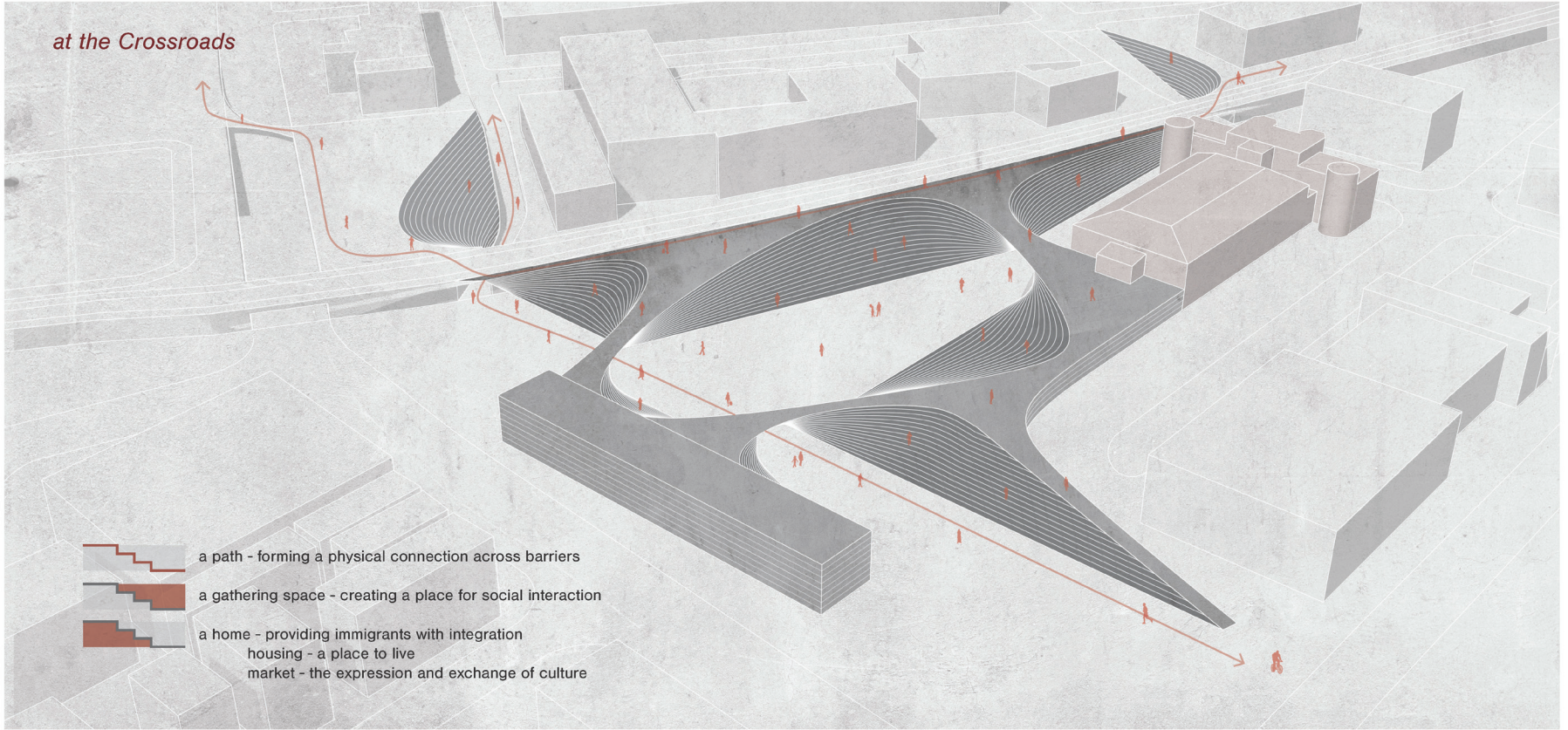

drawing from the city

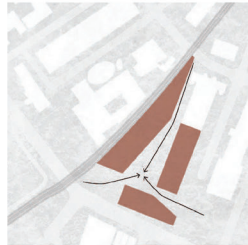

connecting the ground level

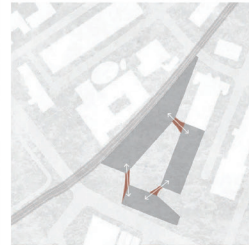

connecting the upper level

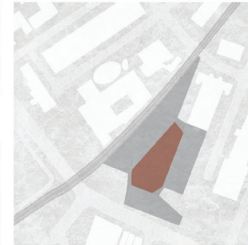

creating a central gathering space

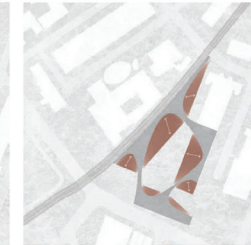

connecting the two levels

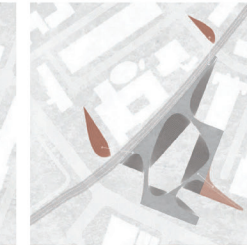

reaching out to the city

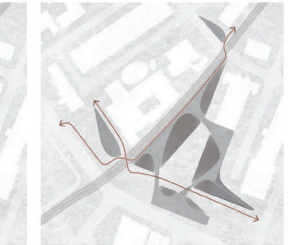

providing circulation to the city

Underneath the Stair

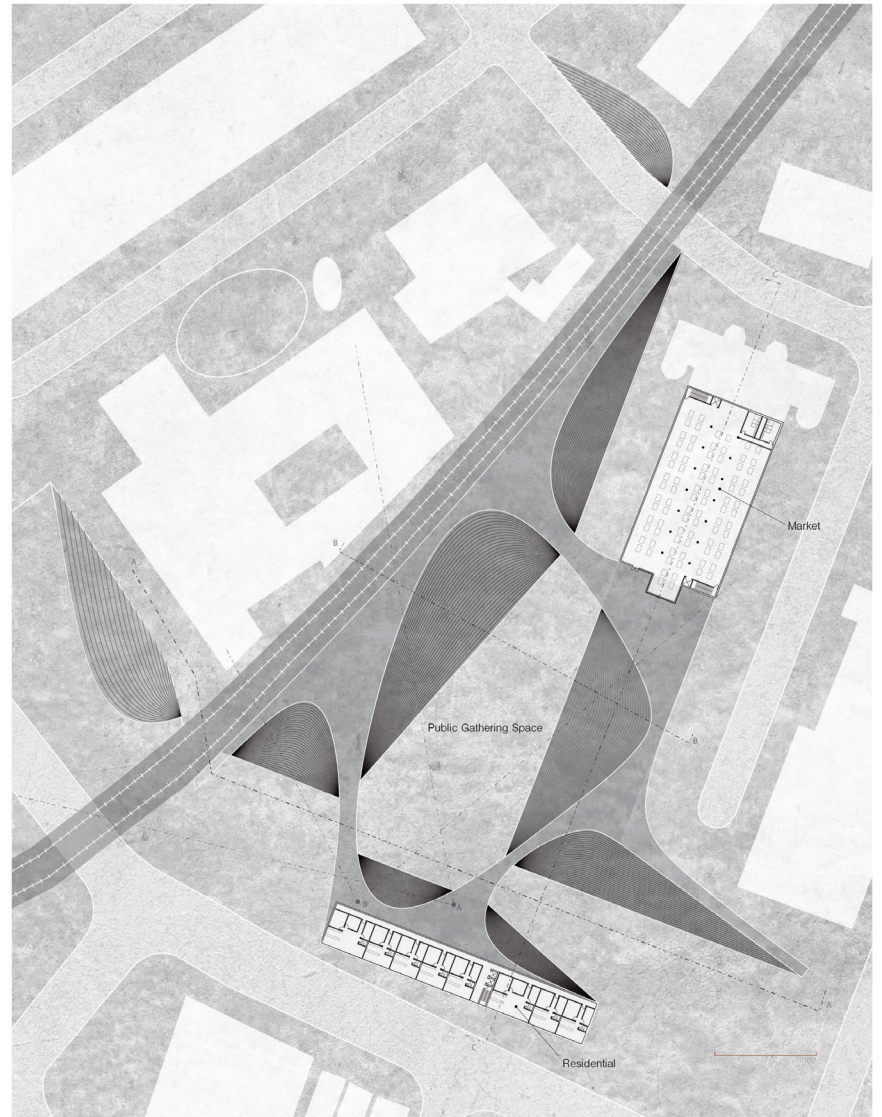



a path - a physical connection

- crossing barriers
- topography
 - railroad
 - separation

tying the city together

- the ground path
- connecting the riverfront to town core
 - crossing under the railroad through the existing underpass

- the elevated rail path
- connecting the basilica to transit station
 - running along the railway and bridging over roads

- the crossroads
- an interchange, a junction between paths
 - connecting the ground path and the elevated path
 - providing a stair between levels



render A



section A



a gathering space - social interaction

the form

- it provides a public open gathering space
- the staired/terraced form creates seating and outdoor amphitheaters

the crossroads

- a place of interchange and interaction
- bringing different people on different routes through a common location
- where people come together to cross barriers

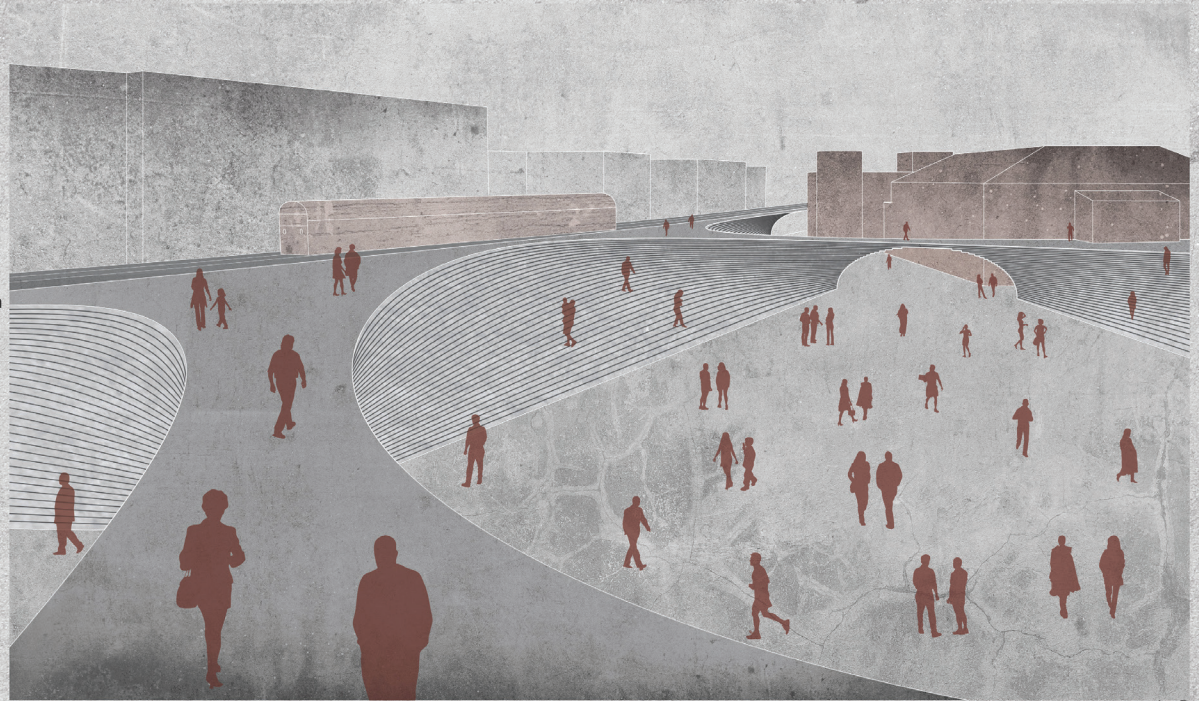

render B

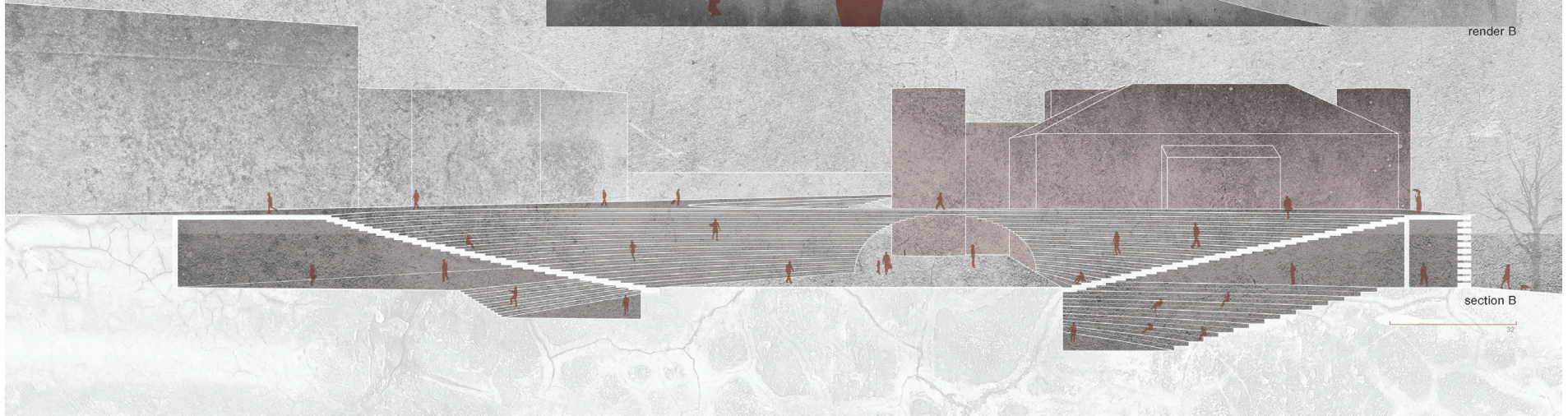

section B



a home - cultural integration
- not only place to live - immigrant housing
- but also a connection to a place - a city
(physical connection - a path)
- and a connection with others - a community
(social interaction - a gathering space)

the crossroads
- a place of interaction with others
- historically, a place of trade/exchange
- a mixing of cultures

the market
- a place of exchange of goods/ideas/culture
- an expression of self and culture

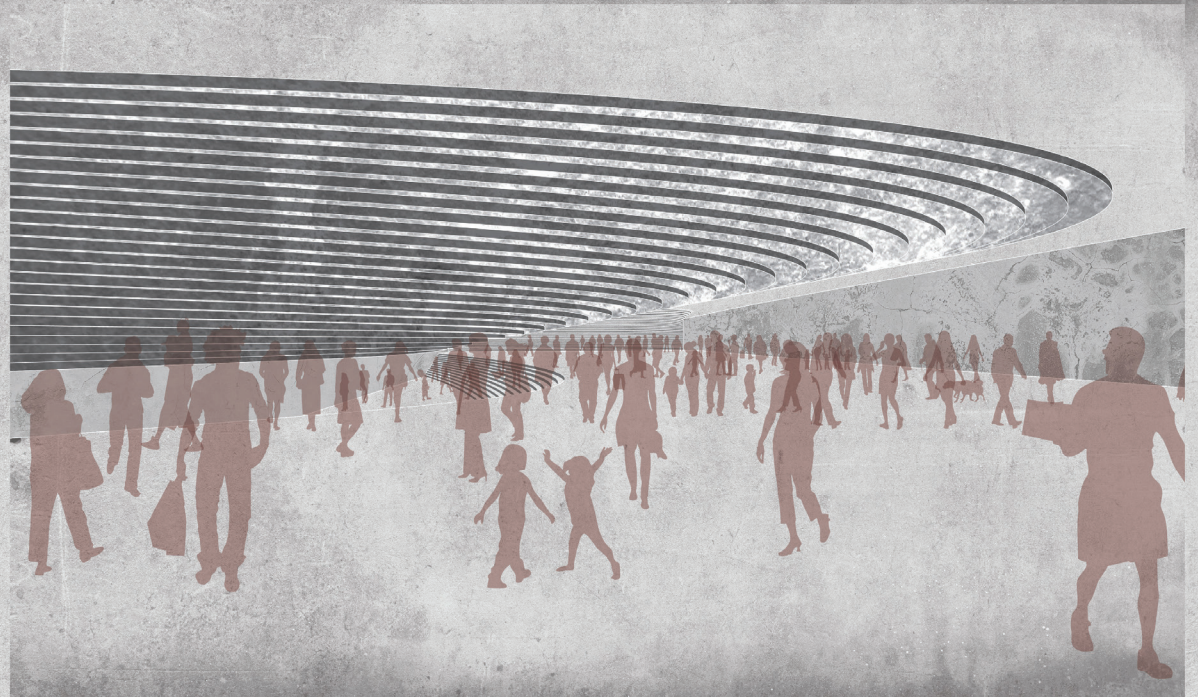

render C

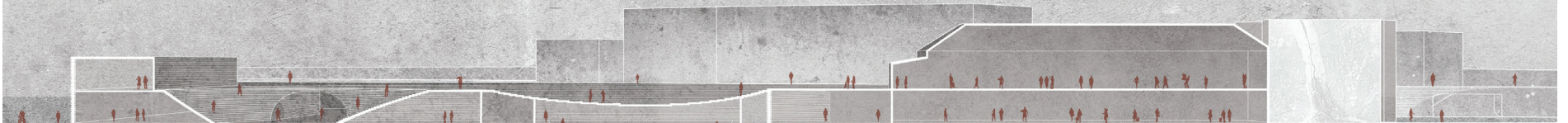

section C

