

2012 MERIT

Cailen Pybus

LYCEUM

A traveling fellowship in Architecture

So at that time I'll be
working at 74m and feel like
I'm being digested by the earth?
Great! I'll set up on terrace E in
June...
In 4 years.

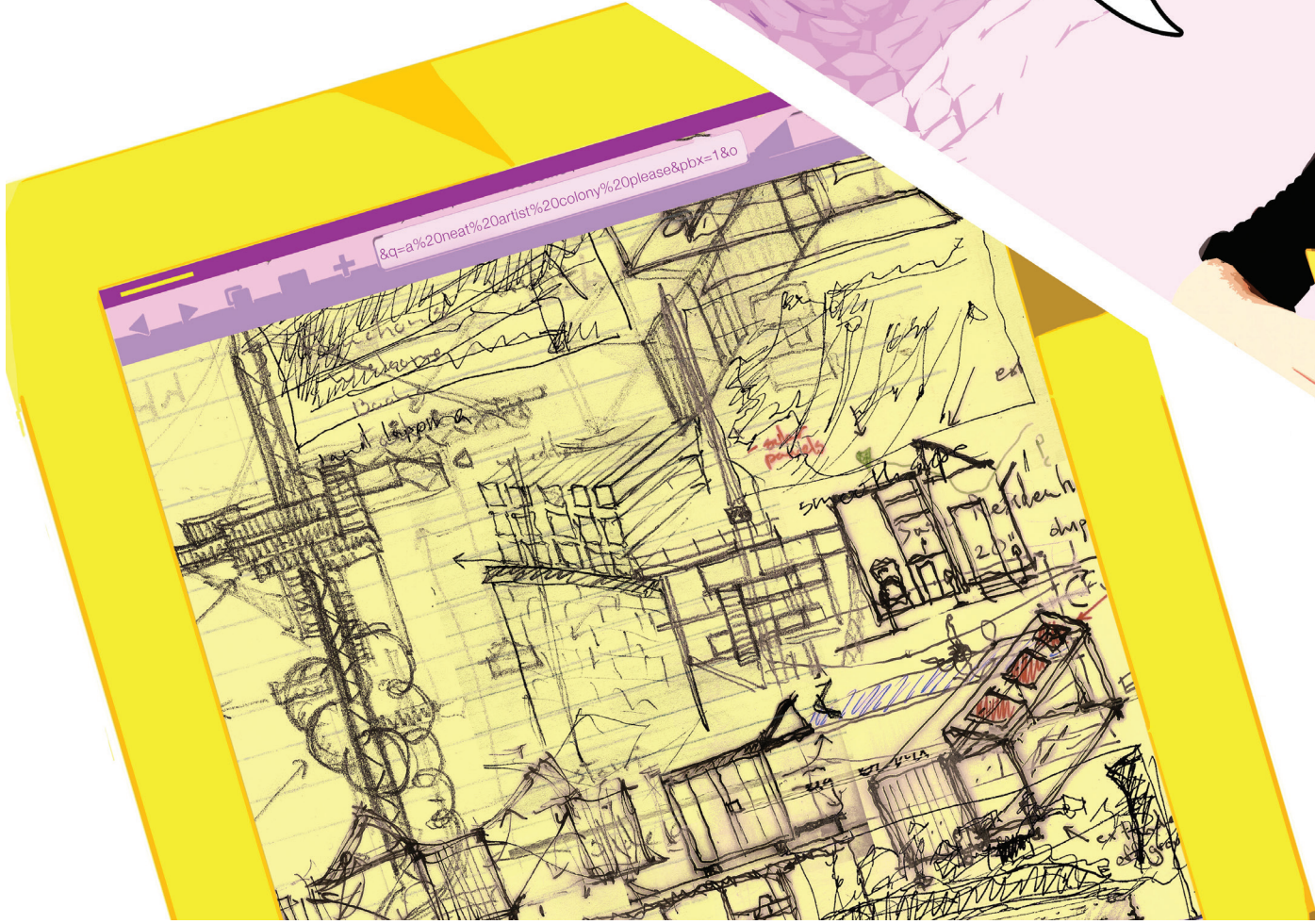

Landscape is a Slow Spectacle



It's been a while since the Wells-Lamson Quarry has seen its last granite boom, and in recent decades as America's importance as a primary resource exporter has declined, the remaining quarries of Vermont find themselves closed or bought-out. This first granite quarry of America, whose stones were shipped far and wide to line the roads of distant countries, now has its story hidden under hundreds of feet of water.

The quarries are closing and unused shipping containers fill the ports. Quarry stone was cut for shipping dimensions, containers that have circled the globe delivering granite will return to the quarry. Pump out the pit to show its story, but slowly, and let it refill. This landscape was altered year to year not day to day.

Art and curiosity will set the pumps running again.

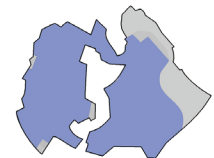

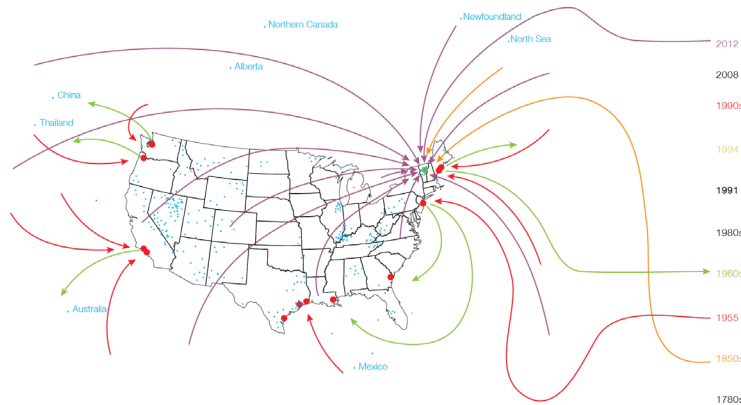

Event Map

- 2012 Artist residency institution created for Wells-Lamson Quarry
- 2008 Global economic recession
- 1990s Trade imbalance produces the "Empty Container Problem"
- 1994 Wells Lamson Quarry water level reaches equilibrium with water table
- 1991 Wells-Lamson closed by Rock of Ages Co, drainage pumps deactivated.
- 1980s Decline of international export of Vermont granite
- 1960s Barre granite exported across the world in shipping containers
- 1955 Implementation of shipping container standard in the United States
- 1850s Immigration of artisanal sculptors to Barre for famous high quality stone
- 1780s Opening of the Wells-Lamson Quarry

Event Timeline

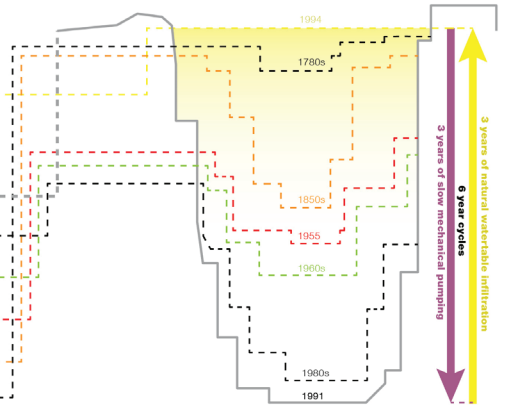
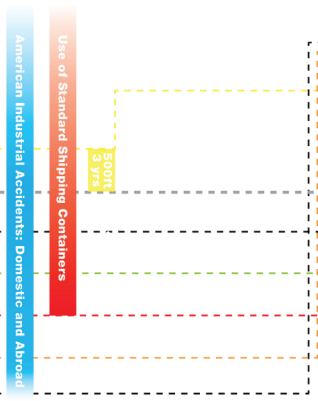

Quarry Section

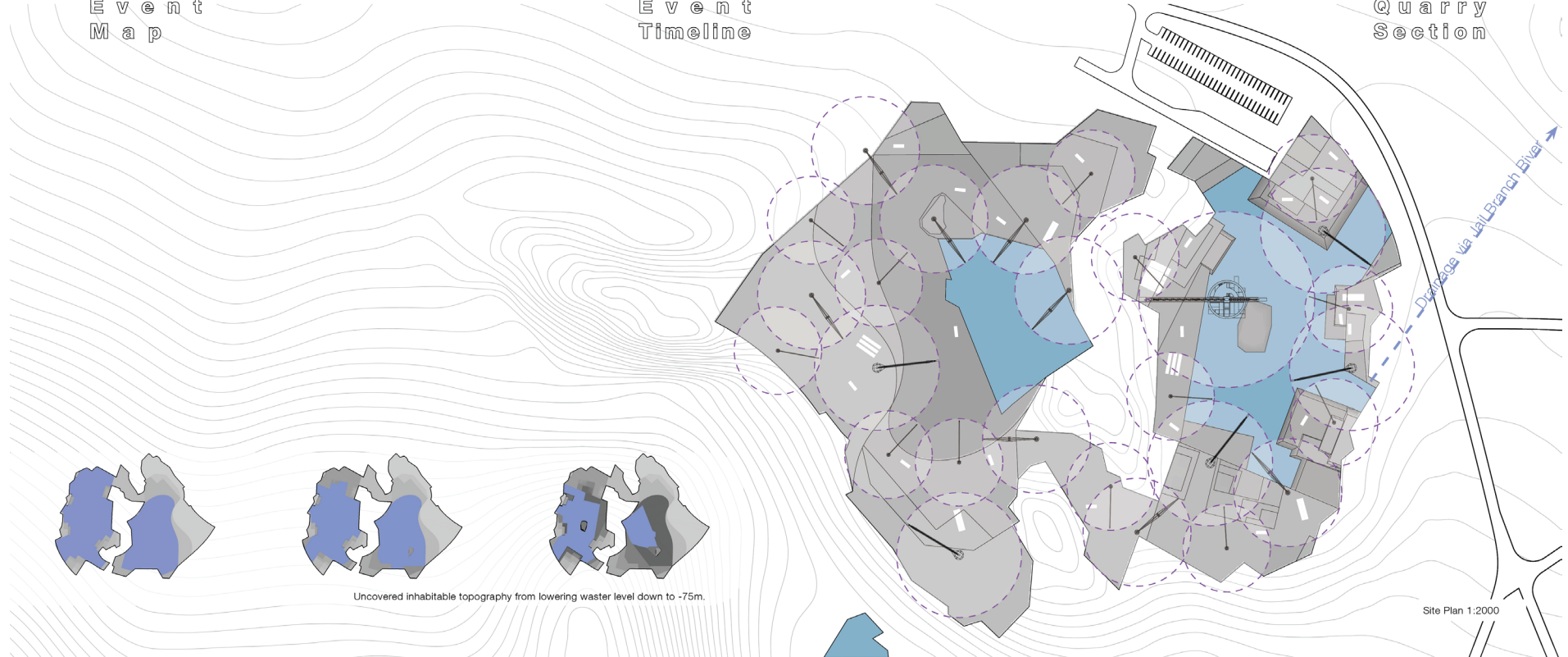

Site Plan 1:2000

Placed

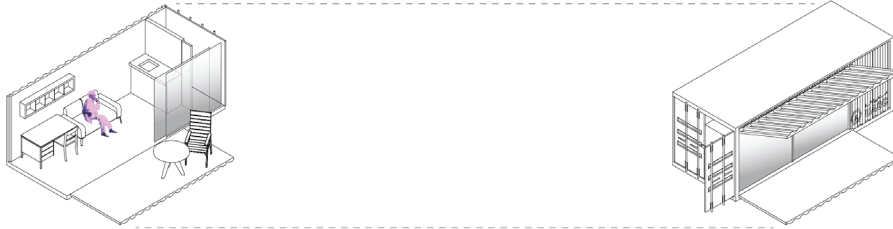

Stacked

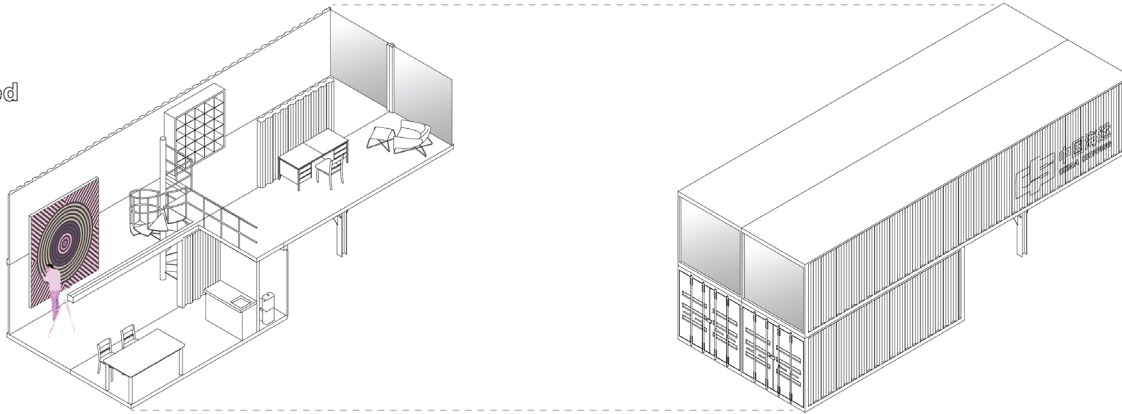

Unfolded

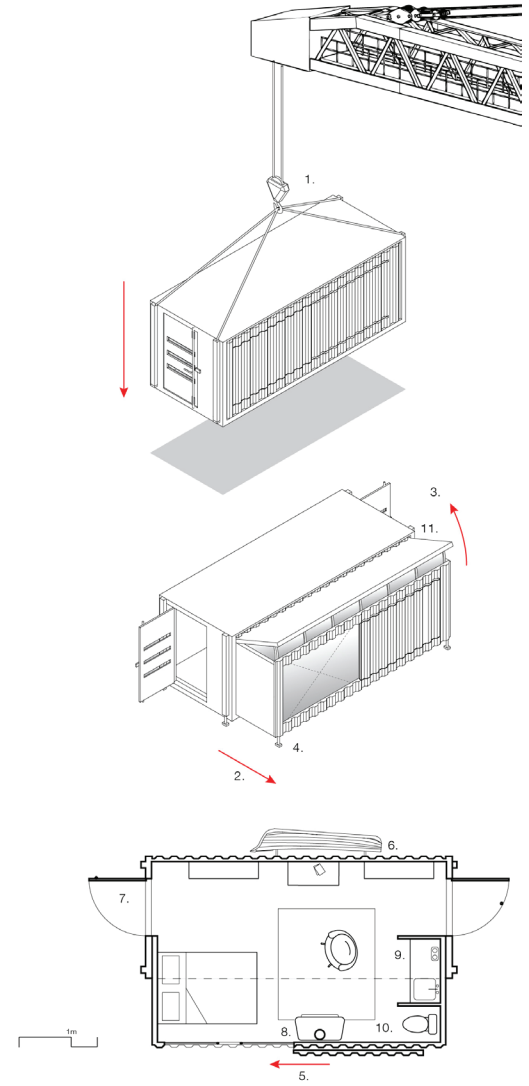
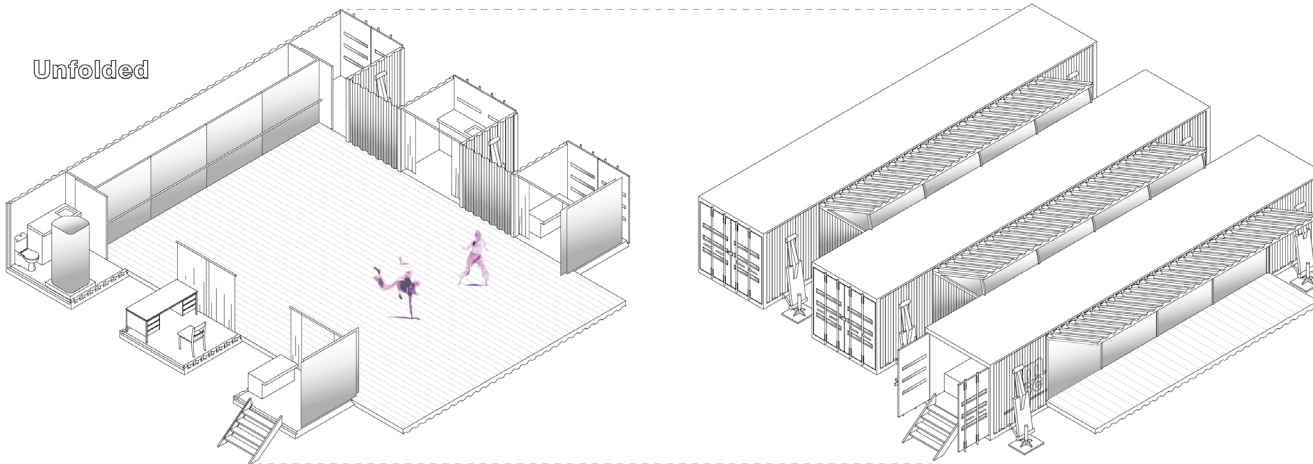

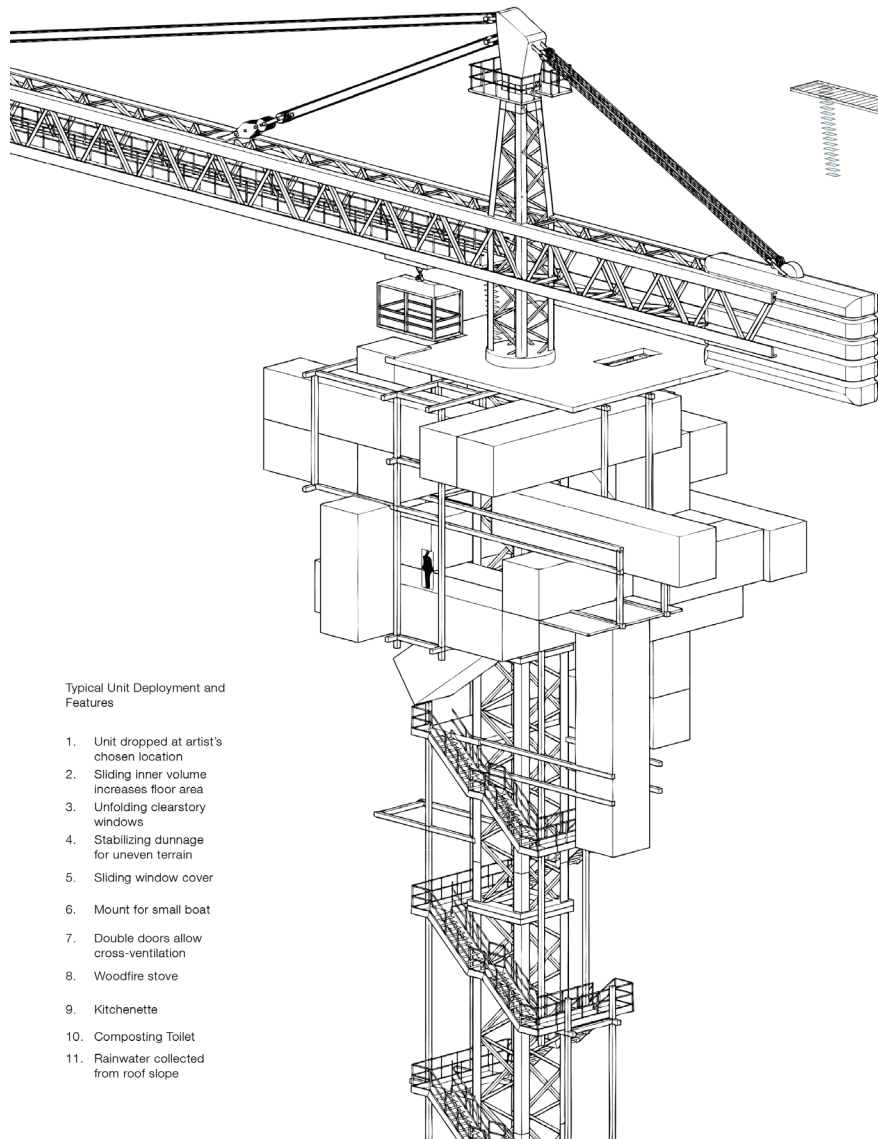

Typical Unit Deployment and Features

1. Unit dropped at artist's chosen location
2. Sliding inner volume increases floor area
3. Unfolding clearstory windows
4. Stabilizing dunnage for uneven terrain
5. Sliding window cover
6. Mount for small boat
7. Double doors allow cross-ventilation
8. Woodfire stove
9. Kitchenette
10. Composting Toilet
11. Rainwater collected from roof slope

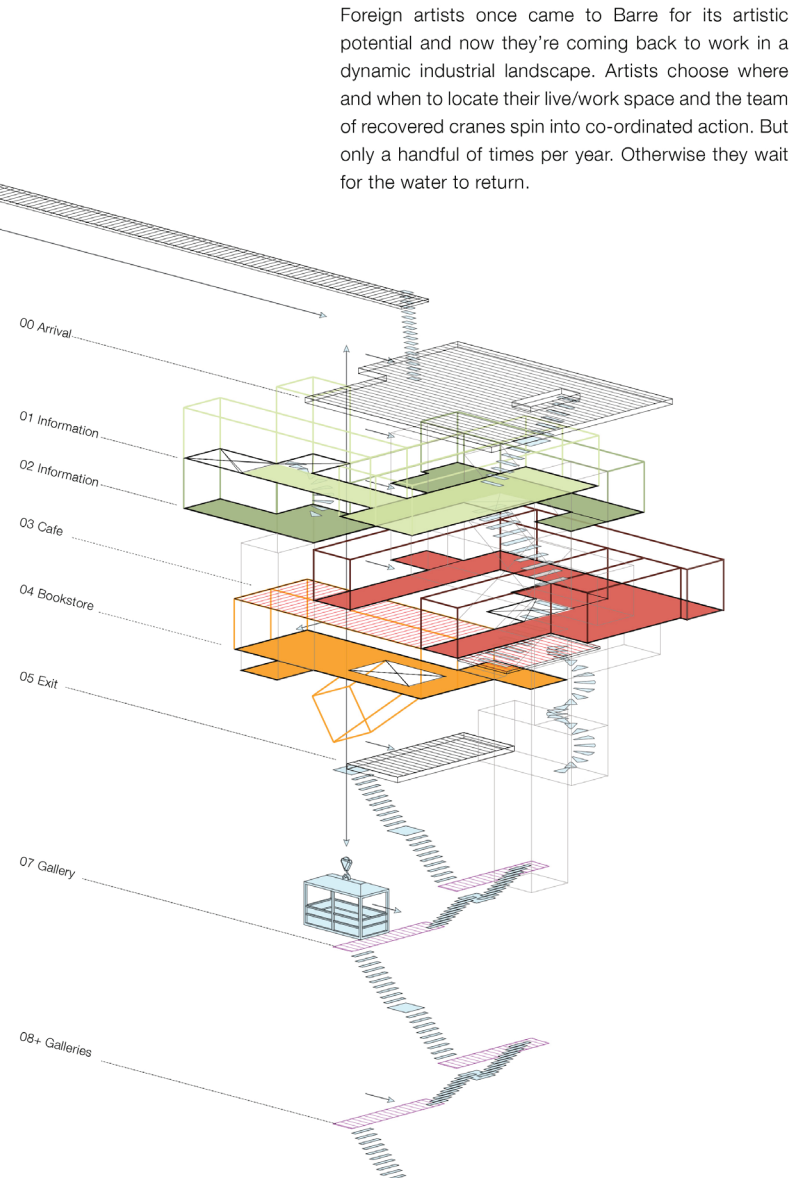

- 00 Arrival
- 01 Information
- 02 Information
- 03 Cafe
- 04 Bookstore
- 05 Exit
- 07 Gallery
- 08+ Galleries

Foreign artists once came to Barre for its artistic potential and now they're coming back to work in a dynamic industrial landscape. Artists choose where and when to locate their live/work space and the team of recovered cranes spin into co-ordinated action. But only a handful of times per year. Otherwise they wait for the water to return.

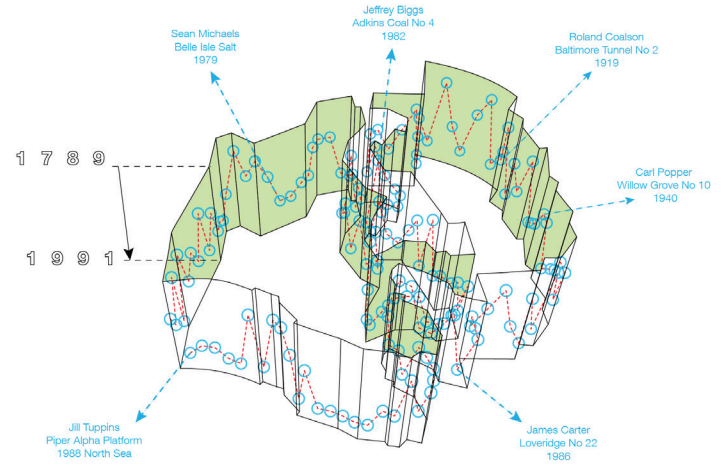

Exploring the walls of the quarry reveals names of Americans who have died in industrial accidents across the world. Each name will be positioned vertically in relation to the quarry's historical depth at the time of the accident, and horizontally in relation to the accidents' location. Names will go in and out of access in relation to the changing water level, and the exploration possibilities will always be gradually changing.

Perhaps a trace of an accident, a recycled container, and a visiting artist might all refer to the same distant place?

