

1990 MERIT

Hendrik R. Krabbendam

LYCEUM

A traveling fellowship in Architecture

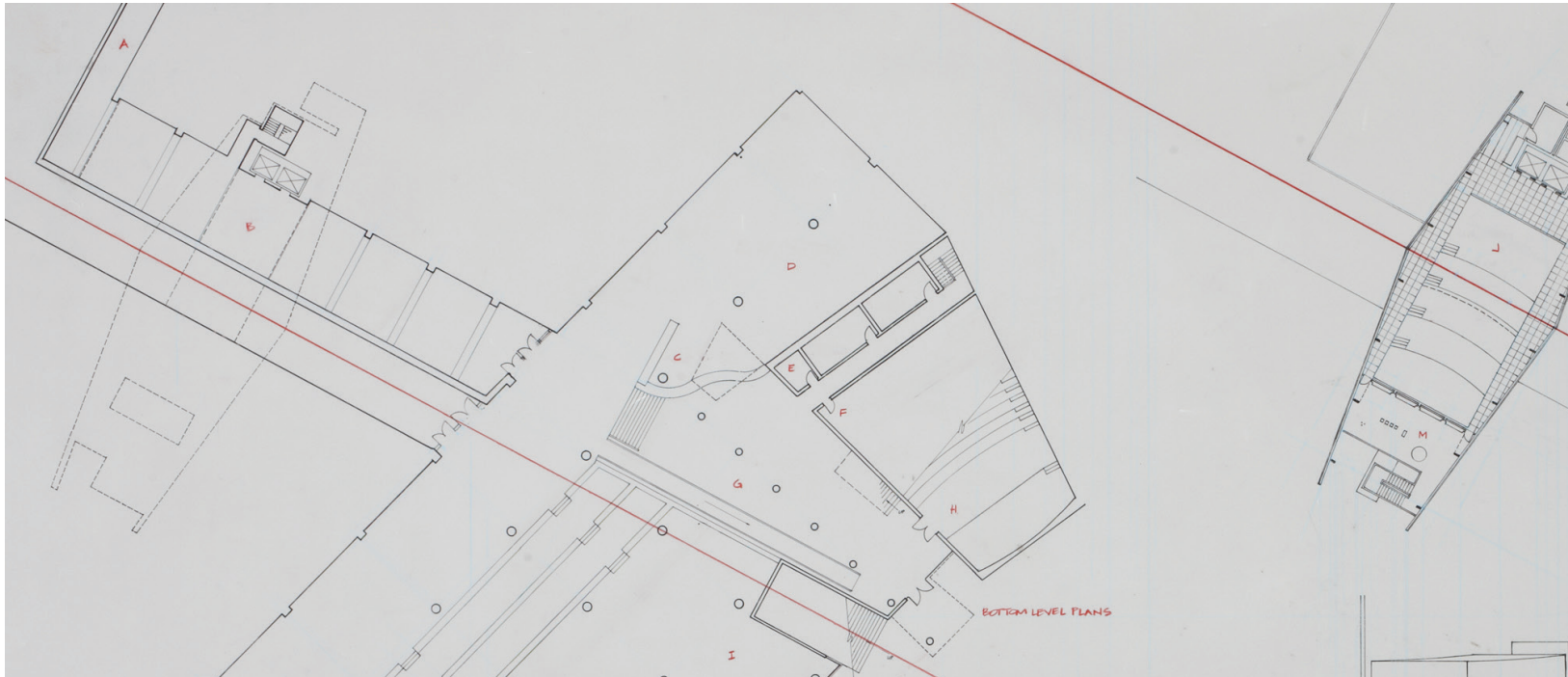

5 FOCUS (PERCENT TO LIBRARY ENTRANCE)
 THROUGHOUT THE PROJECT, ATTENTION IS FOCUSED ON TWO
 CONSTANT REFERENTIALS - SPECTACLE & HAINSBORO ISLANDS -
 WHAT WE MUST DEAL WITH AND WHAT WE ASPIRE TO.

6 FRAME (LECTURE HALL - ROOF OPEN)
 BY CAREFULLY DETAILING THE EDGE OF THE OPENING -
 ELIMINATING ITS PERCEIVED THICKNESS - THE SKY
 BECOMES A LIVING PAINTING

- A CORRIDOR TO LABS
- B TOWER LOBBY
- C CIRCULATION
- D RARE MEDIA
- E SERVICES
- F MECHANICAL
- G EXHIBITION
- H AUDITORIUM
- I READING ROOM
- J NAP ROOM
- K PROJECTION
- L OPEN TO BELOW
- M DATA COLLECTION

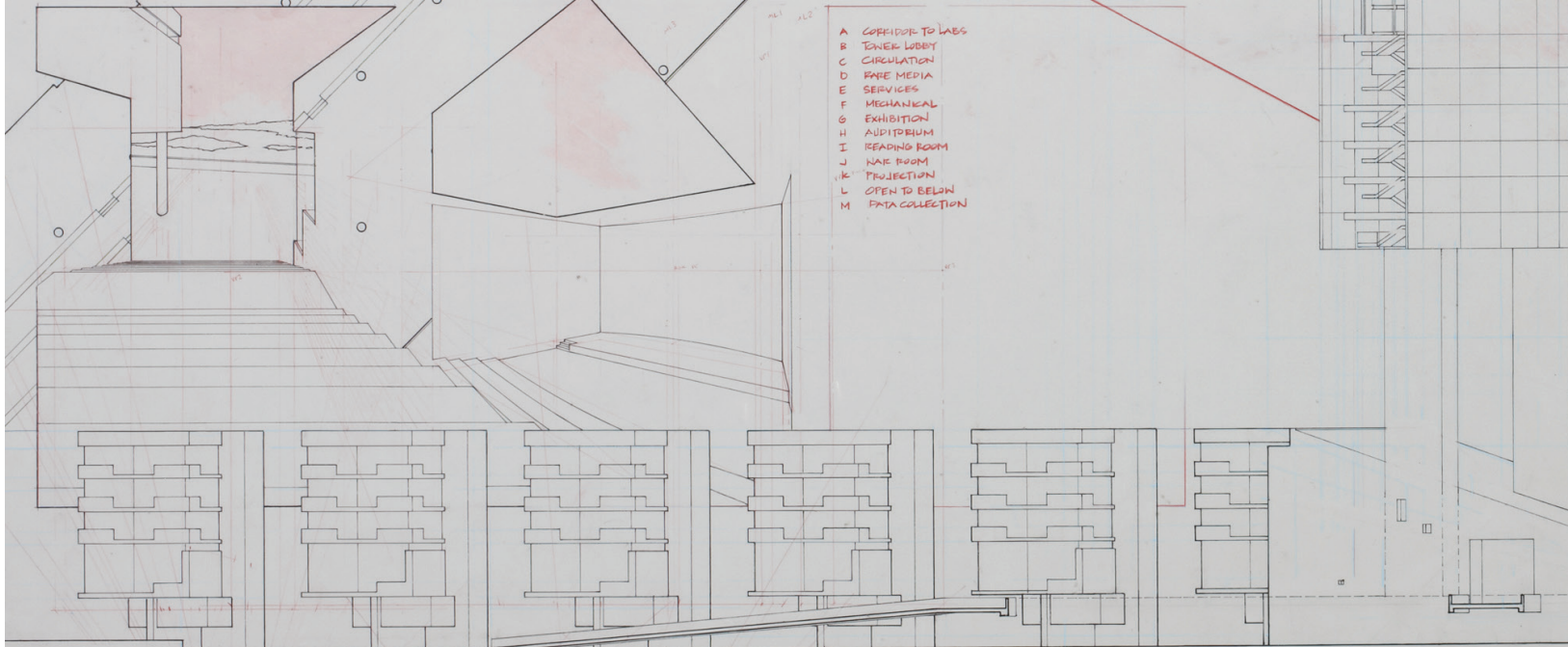

1" = 20'
 0 10 20 40

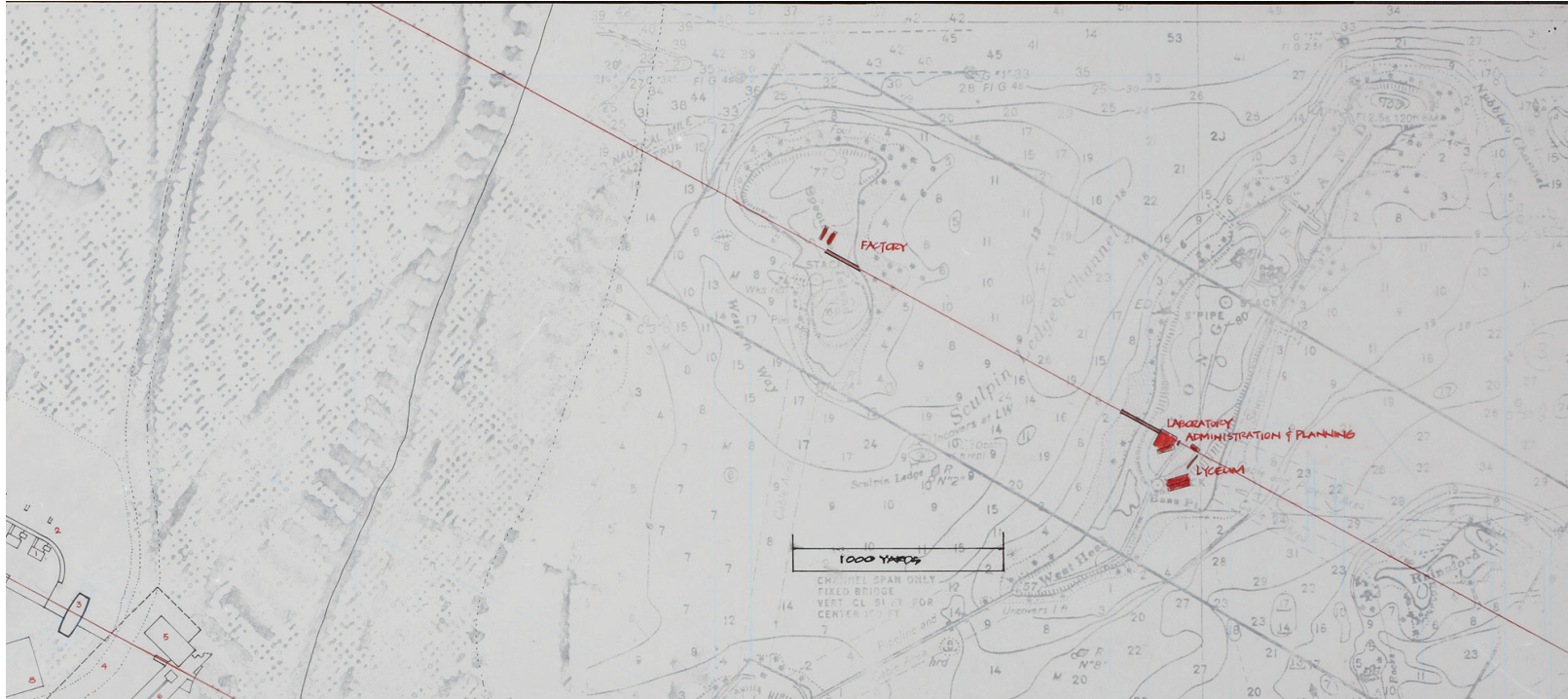

2 SLICE (MAN DOCK, SHIPPING & RECEIVING)
 THE EARTH IS CUT OPEN AND REINFORCED, EXPOSING THE SOIL STRUCTURE AND THE CONTOUR. FOR COMPARISON, BOTH LONG AND SPECTACLE ISLANDS ARE CUT OPEN.

3 JUXTAPOSE (EXPERIMENTAL POOL, OCEAN BEYOND)
 THE EXPERIMENTAL POOL IS DETAILED TO ELIMINATE THE LIP ON THE OCEAN SIDE: THE BOUNDARY BETWEEN POOL AND OCEAN IS LOST AND THE OCEAN IS INVITED INTO THE FOREGROUND.

4 JUXTAPOSE (EXPERIMENTAL POOL, EXPERIMENTAL TREES)
 THE SURREAL TEE, FORCES US INTO NEW WAYS OF SEEING)

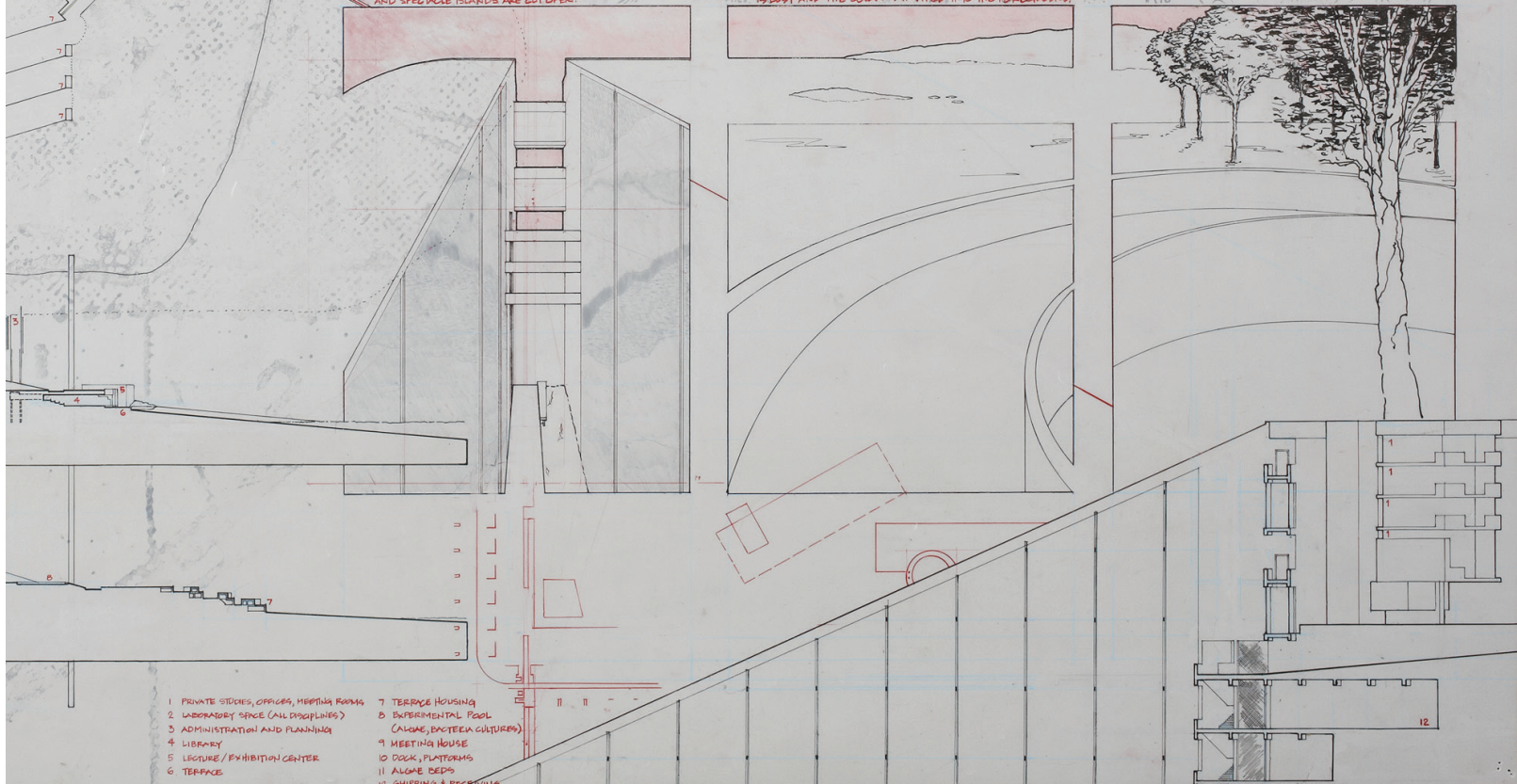

- 1 PRIVATE STUDIOS, OFFICES, MEETING ROOMS
- 2 LABORATORY SPACE (ALL DISCIPLINES)
- 3 ADMINISTRATION AND PLANNING
- 4 LIBRARY
- 5 LECTURE/EXHIBITION CENTER
- 6 TERRACE
- 7 TERRACE HOUSING
- 8 EXPERIMENTAL POOL (ALGAE, BACTERIA CULTURES)
- 9 MEETING HOUSE
- 10 DOCK, PLATFORMS
- 11 ALGAE BEDS
- 12 SHIPPING & RECEIVING